

***Rotational***  
***Moulding***  
*Product Catalogue*

***Linpac***

*Turning good ideas into **great products***



## **Linpac Rotational Mouldings Pty.Ltd**

*Linpac Rotational Mouldings has been providing product solutions for the Australasian markets for over 20 years. Specialising in the rotational moulding process, Linpac Rotational Mouldings forms part of a global network with operations in the UK, Europe, South Africa and the Americas, including the Viscount Plastics group. LINPAC Rotational Mouldings Australia has manufacturing facilities located in Carrum Downs (Vic) and Wagga Wagga (NSW) and offices in Minto New South Wales.*

*We are pleased to present this catalogue highlighting our vast experience in the Materials Handling, Infrastructure and Rural markets. In addition to the extensive range of proprietary products featured we also service the needs of customers with specific requirements. Our design and development department provide the technical support in converting your exciting ideas into reality.*

*Linpac management and staff are committed to providing its customers with the product solutions and the service they expect, giving them a distinct opportunity to increase profitability and broaden their markets.*

*"Linpac turning good ideas into great Products"*



Peter J. Unkles

---

**LINPAC Rotational Mouldings Pty. Ltd.**  
81 Frankston Gardens Drive  
Carrum Downs, 3201, Victoria, Australia.

Tel: (03) 9775 0310 Fax: (03) 9775 1639  
Sales Enquiries: 1300 366 685  
Email: [sales@linpac.com.au](mailto:sales@linpac.com.au)  
ABN:19067462337

---

**LINPAC Wagga Wagga**  
15 Lewington Street  
Bomen, 2650, New South Wales, Australia.

Tel: (02) 6921 4297 Fax: (02) 6921 9807

---

**LINPAC NSW**  
98 Airds Road  
Minto, 2566, New South Wales, Australia.

Tel: (02) 9820 2222 Fax: (02) 9820 3772

---

**LINPAC QLD**  
PO Box 83  
Banyo, 4014, Queensland, Australia.

Tel: (07) 3267 1485 Fax: (07) 3267 1486

[www.linpac.com.au](http://www.linpac.com.au)

# *Index*

<i>Chemical Tanks</i>	1
<i>Safety Products</i>	3
<i>Drums &amp; Buckets</i>	7
<i>Pallets</i>	9
<i>Pallet Bins</i>	9
<i>Rectangular Tanks</i>	11
<i>Rectangular Trays</i>	13
<i>Trolleys</i>	13
<i>Laundry Products</i>	15
<i>Marina Products</i>	15
<i>Floatation Systems</i>	16
<i>Hoppers</i>	17
<i>Waste Products</i>	18
<i>Transporter Tanks</i>	18
<i>Infrastructure</i>	19
<i>Water Tanks</i>	27
<i>Underground Tanks</i>	29
<i>Rural Products</i>	29
<i>Retail Garden</i>	31
<i>Custom Mouldings</i>	33
<i>Moulding Process</i>	34
<i>Mold-in Graphics™</i>	34
<i>Standard Colour Range</i>	34
<i>Chemical Resistance</i>	35
<i>Materials Specifications</i>	35
<i>Terms &amp; Conditions</i>	36

# Chemical Tanks

## Chemmasta Chemical Tanks



Photograph courtesy of Visy Pulp and Paper Pty.Ltd Tumut mill

### Dimensions

Code	Product	Volume	Diameter	Height
CT1605	Closed Head Drum	110Lt	495mm	675mm
CT1647	Nesting Drum	120Lt	540mm	710mm
CT1648	Nesting Drum	218Lt	630mm	920mm
CT1606	Closed Head Drum	218Lt	600mm	865mm
CT1607	Closed Head Drum	260Lt	590mm	1040mm
CT1264	Chemical Tank	400Lt	950mm	845mm
CT1272	Chemical Tank	550Lt	950mm	1145mm
CT1276	Chemical Tank	690Lt	950mm	1340mm
CT1280	Chemical Tank	900Lt	950mm	1350mm
CT1427	Chemical Tank	1100Lt	1060mm	1720mm
CT1423	Chemical Tank	1280Lt	1100mm	1680mm
CT1425	Chemical Tank	1950Lt	1300mm	1870mm
CT1428	Chemical Tank	3200Lt	1580mm	2010mm
CT1412	Chemical Tank Squat	4400Lt	2160mm	1500mm
CT1413	Chemical Tank	4400Lt	1830mm	1950mm
CT1415	Chemical Tank Squat	5800Lt	2450mm	1570mm
CT1414	Chemical Tank	5500Lt	1900mm	2400mm
CT1402	Chemical Tank Squat	9800Lt	3100mm	1640mm
CT1403	Chemical Tank	11800Lt	2600mm	2650mm
CT1404	Chemical Tank	16000Lt	2960mm	2750mm
CT1407	Chemical Tank	22600Lt	3630mm	2500mm
CT1405	Chemical Tank	24700Lt	3670mm	2750mm
CT1406	Chemical Tank	26600Lt	3650mm	3100mm
CT1408	Chemical Tank	34600Lt	4560mm	2560mm
CT1410	Chemical Tank	44500Lt	4560mm	3100mm

\* All dimensions are nominal, for precise dimensions a detailed drawing should be requested

## Features

Linpac Rotational Mouldings manufacture an extensive range of free standing liquid Storage and Chemical Tanks to suit most situations.

Made from chemical resistant, food grade, medium density, linear polyethylene our tanks are capable of handling product up to a specific gravity of 1.6 and an operational temperature range from -18 degrees to + 65 degrees Celsius.

The cylindrical designs have capacities ranging from 110 litres to 44,500 litres while offering both structural integrity and seamless one piece construction.

Our industrial tanks are moulded in either Natural or Black UV stabilised material allowing for both indoor and external applications. The lighter natural colour offers the additional feature of being able to identify the liquid level through the tank wall.

## Customised Tanks

Linpac also offer the ability to customise your tank by presenting a range of compatible tank outlets, vents, anchoring points and access covers that can be positioned to suit your specific site requirements.

Our detailed chemical resistance chart will also assist in ensuring the right selection for your specific needs.

Manufactured from UV stabilised food grade polyethylene which complies with Australian Standard AS2070 and meets US Food and Drug Requirement 177-1520.

## CHEMMASTA



# Chemical Tanks



1100Lt CT1427



260Lt CT1607



400Lt CT1264



218Lt CT1648



218Lt CT1606



110Lt CT1605



120Lt CT1647

## Fittings



Threaded Access Lid



Ventilation Breather



Anchoring Brackets



Table D Flange with Backing Plate



Threaded Female Wall Fittings



Threaded Male Wall Fittings



Sight Glass with single isolation valve

## CHEMMASTA



5800Lt CT1415

11800Lt CT1403

1280Lt CT1423

9800Lt CT1402

# Safety Products Protection range

## Downpipe Protector IN3000



This product is designed to prevent costly damage to downpipes and cars, whilst its flexible design suits both rectangular and circular downpipes. The adaptable low profile construction also provides optimal impact strength without intruding on available car parking space.

- Designed to protect your car as well as your downpipes
- Protects your downpipe from costly damage repairs
- High tolerance to weathering
- Light weight
- High visibility
- Six Fastening points



### Dimensions

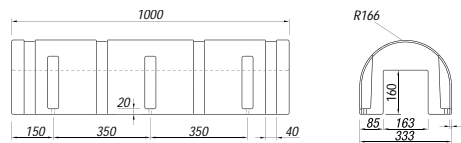

\* Dimensions are nominal, for precise dimensions a detailed drawing should be requested Note: All dimensions in millimetres

## Column Protector IN3005



This innovative product is designed to reduce structural damage by reducing potential impact on 1" beams as well as to protect your valuable equipment. The Column Protector is ideal for structures with high delivery or forklift movement, whilst the low profile construction provides optimal impact strength without reducing your available workspace.

- Reduces structural damage as well as damage to equipment
- Suitable for use with 200, 250 & 310 Universal Columns
- Low profile reduces loss of space
- High tolerance to weathering
- Easily installed and maintained
- High visibility



### Dimensions

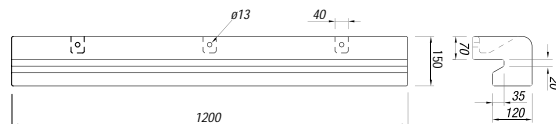

\* Dimensions are nominal, for precise dimensions a detailed drawing should be requested Note: All dimensions in millimetres

## Speed Hump IN3975 - End Cap IN3976



This cost effective alternative to concrete/steel speed humps is ideal for all high traffic areas. Constructed from UV stabilised LLDPE, its resistance to weathering and structural integrity provide excellent long-term load bearing capabilities, while the modular design makes installation easy.

- High tolerance to wear & weathering
- Modular system to suit any carriage ways
- Highly effective in controlling traffic speed
- Coloured for high visibility
- End caps available



### Dimensions

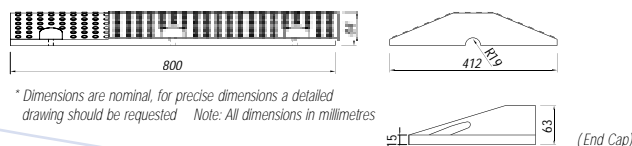

\* Dimensions are nominal, for precise dimensions a detailed drawing should be requested Note: All dimensions in millimetres

## Racking Protector IN3015



This product has been designed to reduce damage to your racking and equipment. Ideal for delivery zones or areas with high forklift movement, the innovative design combines excellent impact strength without compromising your storage space and can be moulded in a range of colours to suit your workplace.

- Easy installation and maintenance
- No colour loss due to weathering
- Reduces damage to racking
- Excellent impact strength
- Quick release fasteners
- High visibility



### Dimensions

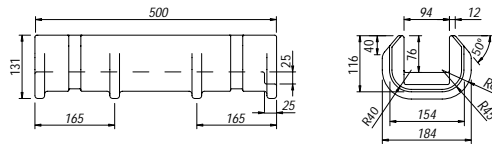

\* Dimensions are nominal, for precise dimensions a detailed drawing should be requested Note: All dimensions in millimetres

## Corner Protector IN3010



The Corner Protector has been designed to reduce damage to your walls or racking. Ideal for both delivery zones or areas with high forklift movement, the innovative design combines excellent impact strength without compromising your storage space. The Corner Protector can also be moulded in a range of colours to suit your workplace.

- Easy installation and maintenance
- No colour loss due to weathering
- Reduces damage to corners or racking
- Excellent impact strength
- Fastening points
- High visibility



### Dimensions

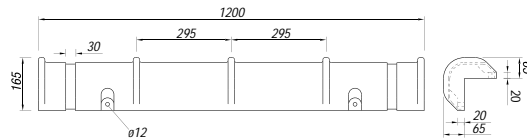

\* Dimensions are nominal, for precise dimensions a detailed drawing should be requested Note: All dimensions in millimetres

## Fender Guard IN4610



Flexibility of design allows this innovative new product to be used for a variety of applications. The Fender Guard is made from UV stabilised LLDPE and cushions the impact of any number of objects including boats, cars and forklifts. This product is ideal for marinas, carparks and factories.

- Saves you money by avoiding costly repair jobs
- Ability to be used in a multitude of applications
- Prevents structural damage
- Bright in colour
- Easily installed



### Dimensions

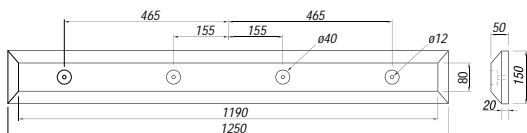

\* Dimensions are nominal, for precise dimensions a detailed drawing should be requested Note: All dimensions in millimetres

# Safety Products Hazard prevention

## Dividing Panel IN3600



This product is designed specifically to reduce noise pollution. The Dividing Panel provides excellent noise reduction capabilities, outstanding anti-weathering properties and good impact resistance. The Dividing Panel has been tested by the CSIRO to AS/NZS 1276.1:1999, successfully passing with a 30 STC (Sound Transmission Class) rating.

- Light weight construction
- Impact resistant
- Interlinking system
- Reduces noise from freeways & factories etc
- Optional colours



### Dimensions

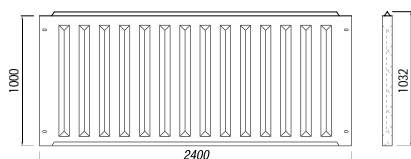

\* Dimensions are nominal, for precise dimensions a detailed drawing should be requested Note: All dimensions in millimetres

## Bunded Pallet MH1627



This portable bunded pallet is designed to contain spillage of both hazardous and non dangerous materials. With a holding capacity of 240 litres, the bunded pallet comes with a formed internal draining floor and a galvanized structural platform. A 50mm threaded drain plug is provided for easy drainage.

### Grid Options

- Galvanized Steel grating
- Galvanized Steel expanded mesh
- Two way forklift access



### Dimensions

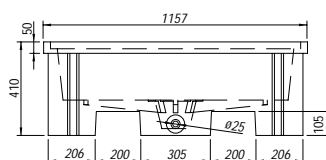

\* Dimensions are nominal, for precise dimensions a detailed drawing should be requested Note: All dimensions in millimetres

## Chemical Bunds



These portable secondary containment devices are made from chemical resistant polyethylene. Designed to be installed under other primary vessels or tanks and prevent spillages of dangerous chemicals. Their light weight enables them to be installed and relocated to where they are needed most.

### Dimensions

Code	Product	Capacity	Diameter	Height
MH1622	Bund	1365Lt	1830mm	600mm
MH1623	Bund	1365Lt	2480mm	320mm
MH1625	Bund	3400Lt	2950mm	490mm

\* Dimensions are nominal, for precise dimensions a detailed drawing should be requested



## Secure Step IN3020



The new Linpac Secure Step has been designed to allow the user to reach higher places safely. With four way access the Secure Step offers a safe brightly coloured, work platform with large contrasting anti-slip pads on all contact surfaces. Nestable for easy storage, lightweight and with optional rubber feet, the Linpac Secure Step is a step ahead of the rest.

- Sturdy yet light weight construction
- Nestable for compact storage
- Optional rubber feet
- Four way access
- Anti-slip pads
- High visibility

### Dimensions

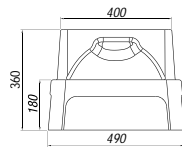

\* Dimensions are nominal, for precise dimensions a detailed drawing should be requested Note: All dimensions in millimetres



## Drum Lid MH1771

Protect your steel drums from water damage when exposed to the external environment. This simple but cost effective weather cap eliminates the ingress of water and prevents corrosion to the surface of the drum. The bright colour acts as a visual reference when in use.

- Prevents corrosion & water damage
- No colour loss due to weathering
- Excellent impact strength
- High visibility



### Dimensions

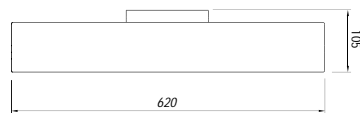

\* Dimensions are nominal, for precise dimensions a detailed drawing should be requested Note: All dimensions in millimetres



## Wheel Stop IN3610

Moulded from UV stabilised tough polyethylene the Linpac wheel stop offers a strong robust approach to safety. Available in a range of colours this wheel stop can stand out or blend into its surroundings. Easy to install and maintain this wheel stop has been designed to suit most vehicles.

- High visibility
- Easy to install and maintain
- High tolerance to weathering
- Designed to suit all vehicle types
- Can be moulded to suit your colour scheme or to blend into the surrounding environment

### Dimensions

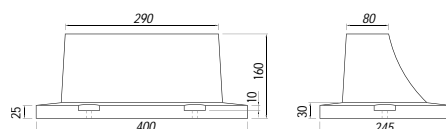

\* Dimensions are nominal, for precise dimensions a detailed drawing should be requested Note: All dimensions in millimetres



# Drums & Buckets

## Calibrated Bucket & Industrial Drum

There is no other bucket like it, the 25 litre calibrated bucket with optional lid comes complete with a polished 6mm stainless steel handle. This strong safety bucket is suitable from the farm to the factory.

The 60 litre Industrial transport Drum offers the ability to store product in the most economical way. This robust cylinder is designed to be mounted on its side under the deck of most trailers. The large fill port and quick action 20mm drain tap allows easy decanting of the contents when mounted on its side. Made from food grade polyethylene, this container is ideal in storing and transporting water and chemicals. Available in a range of standard colours.



125Lt Closed Head Drums on two Bunded Pallets

### Dimensions

Code	Product	Diameter	Height	Volume
MH1640	40Lt Nesting Drum	430mm	460mm	40Lt
MH1641	40Lt Nesting Drum Lid	435mm	40mm	-
MH1643	58Lt Nesting Drum	490mm	450mm	58Lt
MH1644	58Lt Nesting Drum Lid	510mm	45mm	-
MH1647	115Lt Nesting Drum	540mm	710mm	115Lt
MH1649	115Lt Nesting Drum Lid	545mm	45mm	-
MH1648	215Lt Nesting Drum	630mm	920mm	215Lt
MH1653	215Lt Nesting Drum Lid	635mm	45mm	-
MH1605	125Lt Closed Head Drum	495mm	675mm	125Lt
MH1606	235Lt Closed Head Drum	600mm	865mm	235Lt
MH1607	265Lt Closed Head Drum	590mm	1040mm	265Lt
IN3829	60Lt Transport Drum	385mm	590mm	60Lt
MH1600	25Lt Calibrated Bucket	315mm	375mm	25Lt
MH1601	25Lt Calibrated Bucket Lid	320mm	40mm	-
TA1264	450Lt Circular Tank	950mm	845mm	450Lt
TA1268	590Lt Circular Tank	950mm	1045mm	590Lt
TA1272	680Lt Circular Tank	950mm	1145mm	680Lt
TA1276	800Lt Circular Tank	950mm	1345mm	800Lt

\* All dimensions are nominal, for precise dimensions a detailed drawing should be requested

## Closed Head Drums

Linpac offer a range of closed head drums for the storage of liquids and powders. Designed to offer clear smooth internal walls with 150mm sealable screw lid, these containers offer strength, easy access and calibrated level indicators. These products are moulded with food grade polyethylene and are available in Blue or Natural. The moulded in 20mm (3/4" BSP) outlet allows for optional discharge.



125Lt Closed Head Drum MH1605



235Lt Closed Head Drum MH1606



265Lt Closed Head Drum MH1607

# Drums & Buckets

## Tapered Drums

Designed to be nested when empty, these space saving robust containers range in sizes from 40 to 215 litres with optional lids and handles. They are ideal for both liquid and powder storage with easy access for dispensing. Available in Black and Natural as stock items, special colours available on request.



**40Lt Nesting Drum** MH1640



**215Lt Nesting Drum/Lid** MH1648/1653



**58Lt Nesting Drum** MH1643



**25Lt Calibrated Bucket/Lid** MH1600/1601



**115Lt Nesting Drum W/Lid** MH1647/1649



**60Lt Transport Drum** IN3829

## Circular Tanks

Designed to allow easy access with a large full size removable lid, this range of medium sized tanks is used as general storage tanks. They can be customised to suit your specific needs with a large range of tanks and outlets available.



**450Lt Circular Tank** TA1264



**680Lt Circular Tank** TA1272



**800Lt Circular Tank** TA1276

# Pallets & Pallet Bins



**Flat Top Pallet Raised Edge** MH1673



**Flat Top Pallet** MH1672



**Poly Box** MH1705



**1500Lt Pallet Bin** MH1690



**1500Lt Pallet Bin Lid** MH1691 **to suit** MH1690



**1000Lt Pallet Bin Lid** MH1631 **to suit** MH1630

## Insulated Bins

The 1000 litre and 1500 litre insulated Bins are designed to improve the overall performance in comparison to conventional cooler bins. The smooth inner walls and flat floor ensure valuable cargo is not bruised or distorted while making them easy to clean. The insulated walls and base ensure a totally integrated structure offering wall strength and the ability to be stacked two high.

Linpac Insulated Bins are made from food grade polyethylene and are UV stabilised for long term performance in the tough Australian climate. Available with optional mould in corporate identification, numbering and a range of colours.



**1500Lt Insulated Bin-Lid** MH1750 - MH1752

# Pallet Bins



**Bunded Pallet** MH1627



**1000Lt Pallet Bin** MH1630



**Foldable Pallet Bin** MH1637



**1000Lt Insulated Bin-Lid** MH1629 - MH1628

## Pallets & Pallet Bin Features

The **Flat Top Pallet & Raised Edge Pallet** are rotationally moulded to the Australian pallet size of 1165 x 1165mm and offers 4-way access. The clean lines ensure hygienic application while offering tough performance.

The **Bunded Pallet** has been designed to contain spillage of hazardous and non-hazardous materials. This robust product has a 240 Litre containment capacity combined with a channelled sump and release bung for easy drainage. This unit also has two way forklift entry and can stack up to ten high for transport or storage.

The **Poly Box** has been designed to carry solid material and with forklift entry is easy to both tip and transport. The multifunctional split door also allows greater flexibility of applications.

The **1500Lt Pallet Bin** has a steel reinforced lip for added strength & rotatable forklift entry. The Pallet Bin is made from Food Grade Polyethylene and can stack for transport or nest two high.

The **1000Lt Pallet Bin** is made from Food Grade Polyethylene and can be stacked up to four high with forklift entry making storage or transport easy.

The **Foldable Pallet Bin** is perfect for the storage and transport of a wide range of materials, from automotive components to raw materials. Quick release clips allow the product to be easily folded to a height of 310mm for transport & storage. Two way fork lift entry also allows ease of transport for large or small product volumes.



## Dimensions

Code	Product	Volume	Capacity	Width	Length	Height
MH1673	Pallet	-	500Kg	1165mm	1165mm	150mm
MH1672	Pallet	-	500Kg	1165mm	1165mm	150mm
MH1627	Bunded Pallet	240Lt	210Kg	1157mm	1157mm	410mm
MH1705	Poly Box	865Lt	1400Kg	1170mm	1215mm	965mm
MH1690	Pallet Bin	1500Lt	1500Kg	1155mm	1330mm	1395mm
MH1691	Pallet Bin Lid	-	-	1180mm	1350mm	60mm
MH1630	Pallet Bin	1000Lt	1500Kg	1100mm	1100mm	1150mm
MH1631	Pallet Bin Lid	-	-	1230mm	1230mm	85mm
MH1637	Foldable Bin	850Lt	1000Kg	1120mm	1140mm	840mm
MH1750	Insulated Bin	1500Lt	1500Kg	1160mm	2150mm	893mm
MH1752	Insulated Lid	-	-	1160mm	2150mm	50mm
MH1629	Insulated Bin	1000Lt	1000Kg	1170mm	1170mm	1110mm
MH1628	Insulated Lid	-	-	1170mm	1170mm	50mm

\* All dimensions are nominal, for precise dimensions a detailed drawing should be requested

# Rectangular Tanks & Containers

## Product Features

Versatile in both size and shape this extensive range of rectangular containers can solve all your storage problems. These straight wall containers with robust top flanges are suitable for products ranging from food items to general materials and even chemical applications. Moulded in tough polyethylene these storage tanks also have the options of trolley bases for easy relocation and lids for that extra protection of their contents. With capacities ranging from 140 litres to 1380 litres these tanks will cover your needs. A range of colours are available. Trolley options are shown on page 13.



455Lt Rectangular Tank and B Type Trolley 20ST0003

## Dimensions

Code	Product	Volume	Length	Width	Height
TA1209	Rectangular Tank	140Lt	675mm	445mm	545mm
TA1208	Square Tank	165Lt	610mm	610mm	465mm
TA1213	Rectangular Tank	170Lt	660mm	420mm	725mm
MH1665	Square Tank	210Lt	670mm	670mm	590mm
TA1216	Rectangular Tank	250Lt	1020mm	510mm	535mm
TA1220 <sup>†</sup>	Rectangular Tank	300Lt	890mm	590mm	585mm
TA1221	Rectangular Tank	310Lt	610mm	610mm	875mm
TA1224	Rectangular Tank	455Lt	1230mm	610mm	650mm
TA1233	Rectangular Tank	600Lt	1550mm	650mm	610mm
TA1229	Rectangular Tank	690Lt	1240mm	625mm	985mm
TA1238	Rectangular Tank	990Lt	1885mm	680mm	860mm
TA1240	Rectangular Tank	1220Lt	1830mm	810mm	840mm
TA1244	Rectangular Tank	1380Lt	1905mm	920mm	805mm
TA1217	Rectangular Lid	-	1150mm	630mm	45mm
MH1666	Square Lid	-	670mm	670mm	50mm
TA1210	Rectangular Lid	-	735mm	735mm	40mm
TA1225	Rectangular Lid	-	1390mm	740mm	40mm

<sup>†</sup> Product not shown \* All dimensions are nominal, for precise dimensions a detailed drawing should be requested



140Lt Rectangular Tank TA1209



250Lt Rectangular Tank TA1216



690Lt Rectangular Tank TA1229



Lid for TA1216 TA1217

# Rectangular Tanks



**165Lt Square Tank** TA1208



**170Lt Rectangular Tank** TA1213



**210Lt Mobile Food Bin** MH1665



**310Lt Rectangular Tank** TA1221



**455Lt Rectangular Tank** TA1224



**600Lt Rectangular Tank** TA1233



**990Lt Rectangular Tank** TA1238



**1220Lt Rectangular Tank** TA1240



**1380Lt Rectangular Tank** TA1244



**210Lt Mobile Food Bin Lid** MH1666



**Lid for TA1208 & TA1221** TA1210



**Lid for TA1224 & TA1229** TA1225

# Rectangular Trays

## Product Features

From produce to parts, fish to fruit, these strong, food grade storage trays are designed for strength and built to last. With smooth internal surfaces the Linpac rotational moulded trays offer the performance and ability to be easily cleaned, a necessity in today's processing plants. The large 120 litre tray can be stacked and nested for added savings in storage and transport.

## Dimensions

Product	Code	Width	Length	Height	Volume
50Lt Tray	MH1620	550mm	800mm	120mm	50Lt
95Lt Tray	MH1621	800mm	1050mm	120mm	95Lt
120Lt Tray	MH1659	540mm	1160mm	200mm	120Lt

\* All dimensions are nominal, for precise dimensions a detailed drawing should be requested



**50Lt Rectangular Tray** MH1620



**95Lt Rectangular Tray** MH1621



**120Lt Rectangular Tray** MH1659

# Trolleys

## Roll Dolly Features

The Linpac Roll Dolly has been designed specifically for the Australian market. Designed for easy movement of product in the supermarket industry these dollies can be applied to any industry. The removable handle offers efficient storage of the base which can be stored with or without product. The dollies are also stackable when not in use. The hygienic smooth design allows for easy cleaning.

A recent addition to the range is the roll cage dolly. Offering all the features of the standard unit, the cage has been added to give greater stability for unfriendly loads. The side panels can be removed for easy access and improved storage. Linpac dollies take the load from production to the store.

## Dimensions

Code	Product	Capacity	Length	Width	Height
MH1510	Caged Roll Dolly	400Kg	820mm	770mm	1700mm
MH1680	Roll Dolly	400Kg	770mm	580mm	260mm
MH1678	Flat Top Dolly	400Kg	770mm	580mm	240mm
MH1681	Dolly Handle	-	930mm	370mm	-
MH1665	Mobile Food Bin	210Kg	670mm	670mm	592mm
MH1772	Drum Dolly	200Kg	620mm	620mm	210mm

\* All dimensions are nominal, for precise dimensions a detailed drawing should be requested



**Caged Dolly-Handle** MH1510 - MH1681



# Trolleys

## Dimensions

Code	Type B Trolley	Height	Code	Type C Trolley	Height
20ST0001	To suit MH1665	790mm	20ST0007	To suit TA1213	800mm
20ST0005	To suit TA1209	645mm	20ST0003	To suit TA1224	750mm
20ST0004	To suit TA1208	615mm	20ST0011	To suit TA1229	1085mm
20ST0004	To suit TA1221	1025mm	20ST0013	To suit TA1233	760mm
20ST0006	To suit TA1213	800mm	20ST0015	To suit TA1238	990mm
20ST0020	To suit TA1216	645mm	20ST0017	To suit TA1240	990mm
20ST0010	To suit TA1224	750mm	20ST0018	To suit TA1244	955mm
20ST0010	To suit TA1229	1085mm			
20ST0012	To suit TA1233	760mm			
20ST0014	To suit TA1238	990mm			
20ST0016	To suit TA1240	990mm			
20ST0019	To suit TA1244	955mm			

\* All dimensions are nominal, for precise dimensions a detailed drawing should be requested

## Trolley Features

The drum trolley is designed for the smaller range of circular drums with diameters up to 600mm. This castor based trolley can handle loads up to 200kg.

The ability to move great loads of goods from one station to another safely offers savings in both time and effort. The zinc plated heavy duty Linpac trolley system is designed to suit our extensive range of rectangular tanks.

The heavy duty trolley comes standard with 2 x fixed and 2 x swivel 100mm diameter grey non-marking castors. The full support trolley offering additional side wall support, comes standard with 2 x fixed and 2 x swivel 100mm grey non-marking wheels and optional rubber corner protectors.

The mobile food bin trolley has been specifically designed for the storage and movement of food product. Often seen in use under work benches to hold scrap or off cuts. This versatile container has an optional lid and is supported by the zinc plated heavy duty chassis with 4 x 100mm nylon swivel castors.



**Flat Top Dolly-Handle** MH1678 - MH1681



**Roll Dolly-Handle** MH1680 - MH1681



**Drum Dolly** MH1772



**Type B Tank Trolley** 20ST0010



**Type C Tank Trolley** 20ST0003



**Mobile Food Bin Trolley** 20ST0001

# Laundry Products

## Product Features

The Linpac Laundry trolley has been designed to suit the delivery and collection of linen in hospitals, motels, resorts and other facilities. Complete with a removable coated shelf and 2 x fixed and 2 x swivel 100mm non marking brake castors, the linen trolley can be easily cleaned, handled and has an optional fabric cover.

## Dimensions

Code	Product	Length	Width	Height
MH2027	Laundry Trolley	1160mm	645mm	1525mm

\* All dimensions are nominal, for precise dimensions a detailed drawing should be requested

## Fittings



- Reinforced plastic coated shelving
- Durable cover
- Quick release straps
- Non marking brake Castor wheels
- Handle



Laundry Trolley MH2027

# Marina Products

## Product Features

Linpac manufacture a range of marina products to suit both commercial and domestic applications. The polyethylene modular floats are designed to be mounted to either a galvanised steel or aluminium framework that is then covered by the decking. The fully enclosed UV stabilised polyethylene floats have the option of being filled with either polyurethane or polystyrene foam for positive displacement.

The FL3023 pontoon float has the upper surface recessed to allow access for the various services that may be required. The FL3000 and FL3001 Marine floats utilise a flat top deck for easy mounting and full upper support. The polyethylene top deck surface has been tested and certified by the CSIRO to comply with the requirements for walkway surfaces and offers a high slip resistant surface. The deck is available in a range of colours and is designed to suit the pontoon style FL3023. Other components available include a moulded fender, pile cones and a moulded service pillar and light.

## Dimensions

Code	Product	Length	Width	Height	Capacity
FL3050	Pontoon Deck	1200mm	600mm	-	-
FL3023	Pontoon Float	1300mm	1080mm	600mm	725Lt
FL3000	Marine Float	1220mm	910mm	560mm	620Lt
FL3001	Marine Float	1220mm	910mm	635mm	730Lt
MA3303	Boat Fender	600mm	150dia	-	-

\* All dimensions are nominal, for precise dimensions a detailed drawing should be requested

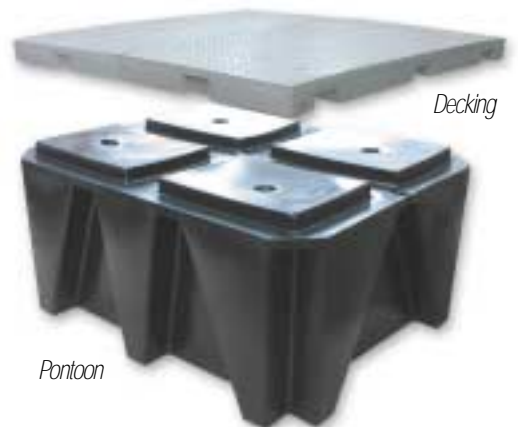

Pontoon Decking & Pontoon Float FL3050 - FL3023



Boat Fender MA3303

# Floatation Systems

## Product Features

At Lincpac we understand the importance of keeping things afloat. With a range of collar, slurry, hose and pipe line floats, Lincpac have the answer to all those sinking questions. Easy to install and made from chemical resistant, UV stabilised, tough rotationally moulded polyethylene, these floats are designed to suit the toughest marine environments.

The brightly coloured floats have the added security of being filled with polystyrene foam. From aquaculture to mining, dredging to laying cables and pipes, Lincpac can support your needs with our vast experience and expansive product range.

As part of our comprehensive service, Lincpac has the facilities to design and manufacture customised floatation systems to suit individual requirements. Please contact our sales staff for further inquiries on 1300 366 685.



## Dimensions

Code	Product	Outer Dimensions	Capacity
FL3004	Pipeline Collar 1200mm I.D	2100 OD x 1300L	3015Lt
FL3016	Pipeline Collar 925mm I.D	2100 OD x 1300L	3620Lt
FL3034	Hose/Cable 40mm I.D	460 OD x 508L	83Lt
FL3009	Hose/Cable 50mm I.D	460 OD x 508L	82Lt
FL3019	Power/Cable 90mm I.D	460 OD x 508L	81Lt
FL3033	Power/Cable 70/90mm I.D	460 OD x 508L	81Lt
FL3040	Hose Float 300/70/90mm I.D	670 W x 770 D x 600L	145Lt
FL3012	Hose Collar 100mm I.D	460 OD x 508L	80Lt
FL3013	Hose Collar 300mm I.D	700 OD x 600L	180Lt
FL3014	Hose Collar 400mm I.D	840 OD x 800L	340Lt
FL3032	Hose Collar 500mm I.D	840 OD x 800L	280Lt
FL3008	Hose Collar 570mm I.D	1300 OD x 800L	850Lt
FL3017	Hose Collar 750mm I.D	1300 OD x 800L	700Lt
FL3015	Hose Collar 810mm I.D	1300 OD x 800L	640Lt
FL3020	Slurry Collar 190mm I.D	600 OD x 1100L	270Lt
FL3021	Slurry Collar 250mm I.D	600 OD x 1100L	250Lt
FL3018	Slurry Collar 300mm I.D	600 OD x 1100L	245Lt
FL3028	Pipeline Float	500 OD x 2700L	530Lt
FL3029	Pipeline Float Saddle Small	-	-
FL3030	Pipeline Float Saddle Large	-	-

\* All dimensions are nominal, for precise dimensions a detailed drawing should be requested



**250mm Slurry Collar Float** FL3021



**750mm Hose Collar Float** FL3017



**300/70/90mm Hose Float** FL3040



**Pipe Line Float** FL3028

# Hoppers

## Product Features

Linpac storage hoppers are available in several shapes and sizes. Designed for both liquid and powders these conical based hoppers are supported in a hot dipped galvanized frame that can be tailored to suit your particular requirements with a variety of outlet configurations ranging from 50mm diameter to 200mm diameter, ball valves to slide valves with both horizontal and vertical discharges. The 450mm lid opening allows for easy access. Frames are available in both stacking and standard non-stacking configurations.

## Dimensions

Code	Product	Volume	Width	Height
MH1031	Hopper & Lid	230Lt	630dia	1110mm
MH1722	Hopper 60°	1000Lt	1090mm	1435mm
MH1721	Hopper 60°	1600Lt	1090mm	2035mm

\* All dimensions are nominal, for precise dimensions a detailed drawing should be requested

## Frame Configurations

Linpac storage hoppers are available in several shapes and sizes. Designed for both liquid and powders these conical based hoppers are supported in a hot dipped galvanized frame.



**1600Lt Heavy Duty  
Frame** 20ST0052



**1600Lt Light Weight  
Frame** 20ST0051



**230Lt Frame**  
20ST0050



1600Lt Hopper in frame



**230Lt Hopper & Lid** MH1031



**1000Lt Hopper 60°** MH1722



**1600Lt Hopper 60°** MH1721

# Waste Products

## Product Features

With over 20 years experience in the waste industry Linpac have developed a unique lid. Featuring a multiple position side insert, innovative hinge core, integrated finger grips and cross ribbed design. Linpac waste bin lids are also lightweight and UV stabilised for ease of use and durability.

## Dimensions

Code	Type	Length	Width	Height	Hinge position	Hole size
IN3859	3.0 Metre	1515mm	915mm	110mm	30/30/30mm	30mm
IN3884	3.0 Metre	1515mm	915mm	110mm	60/30/25mm	25mm
IN3840	1.5 Metre	1050mm	915mm	110mm	30/30/30mm	30mm
IN3839	1.5 Metre	1050mm	915mm	110mm	60/30/25mm	25mm

\* All dimensions are nominal, for precise dimensions a detailed drawing should be requested

## Hinge Positions

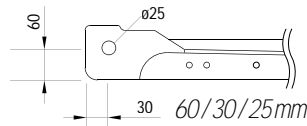
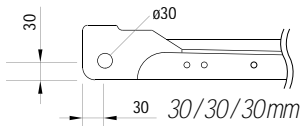

**3.0 Metre Bin Lid** IN3859



**1.5 Metre Bin Lid** IN3840

# Transporter Tanks

## Product Features

Need to move liquids? Then Linpac transporter tanks will suit your needs. With forklift access, these food grade rotationally moulded transporter tanks can be strapped to the trailer or Ute (depending on load ratings) for easy relocation of that vital resource. Ideally used for fire fighting or irrigation the transporter tank can be removed from the base allowing for fast mounting and demounting.

## Dimensions

Code	Volume	Length	Width	Height	Weight Empty	Weight Full	Base Weight
TT1464	-	1525mm	1200mm	40mm	-	-	10Kg
TT1460	800Lt	1525mm	1200mm	800mm	55Kg	860Kg	10Kg
TT1461	1100Lt	1525mm	1200mm	1070mm	70Kg	1200Kg	10Kg

\* All dimensions are nominal, for precise dimensions a detailed drawing should be requested

## Fittings



- 355mm Screw Cap



- Release Bung
- Calibration marks
- Removable Base



**Transporter Tank Base** TT1464



**800Lt Transporter Tank** TT1460



**1100Lt Transporter Tank** TT1461

# Infrastructure Products

## Injection Pits Features

Linpac now have available both injection and rotational moulded underground service pits. The injection moulded pits come in five sizes ranging from the P1 to the split P5 pit. All the injection pits are made from strong black, UV stabilised, high density polyethylene and all are Telstra Approved. The Pits come complete with heavy reinforced side wall panels that can both withstand backfill compaction and offer soil support around the pit to prevent subsidence. The pits can also be reduced in height for shallow installations by removing a section using the cutting guides, then securing with self drilling screws.

## Rotational Pits Features

Linpac manufactures a comprehensive range of polyethylene service pits and lids designed for a range of cabling and Telecommunications applications. The unique design of the Linpac pits provide structural integrity with both rigid sidewall loading capability and exceptional keying into the surrounding soils. The vertical ribbing also offers an important increase in the top load strength of the pits. The built in cutting guides on all pits ensure fast transformations in overall pit height when the application requires a reduction in depth. Linpac pits have been designed, developed and approved in conjunction with the major Australian authorities in Telecommunications and Energy supply. Linpac pits are manufactured in accordance to ISO 9001-2000 standards.



## Dimensions

Code	Product	Length	Width	Height	Lid Aperture
VP0151	P1 Injection Pit	515mm	235mm	400mm	475mm x 200mm
VP0152	P2 Injection Pit	660mm	285mm	570mm	620mm x 250mm
VP0153	P3 Injection Pit	780mm	345mm	630mm	735mm x 300mm
VP0154	P4 Injection Pit	710mm	400mm	830mm	650mm x 350mm
VP0155	P5 Injection Split Pit	713mm	453mm	630mm	653mm x 400mm
UG2001	LP1 Pit	515mm	235mm	400mm	475mm x 200mm
UG2002	LP2 Pit	660mm	285mm	570mm	620mm x 250mm
UG2003	LP3 Pit	780mm	345mm	630mm	735mm x 300mm
UG2004	LP4 Pit	710mm	400mm	830mm	650mm x 350mm
UG2005	LP5 Pit	710mm	455mm	650mm	650mm x 400mm
UG2006	LP6 Pit	1365mm	550mm	670mm	1315mm x 505mm
UG2007	LP7 Pit	1020mm	550mm	1130mm	960mm x 500mm
UG2008	LP8 Pit	1365mm	545mm	895mm	1315mm x 505mm
UG2009	LP9 Pit	2040mm	585mm	900mm	1980mm x 505mm

\*All dimensions are nominal, for precise dimensions a detailed drawing should be requested

**Injection P1 Pit** VP0151

**LP1 Pit** UG2001

**LP6 Pit** UG2006

# Infrastructure Products



**Injection P2 Pit** VP0152



**Injection P3 Pit** VP0153



**Injection P4 Pit** VP0154



**Injection P5 Pit** VP0155



**LP2 Pit** UG2002



**LP3 Pit** UG2003



**LP4 Pit** UG2004



**LP5 Pit** UG2005



**LP7 Pit** UG2007



**LP8 Pit** UG2008



**LP9 Pit** UG2009

# Infrastructure Accessories & Features

## Product Features

The innovative P5 pit has the option to be disassembled for fast easy installations. Made in three sections the pit can be broken down to it's basic elements by simply unclipping the tabs and inserting a flat blade screwdriver between in the slot and twisting. The P5 also has the ability to reposition the base section for modified depth installations. Nestable for easy storage and transport, the injection moulded service pits offer high performance at low cost.

The large range of extension collars are provided for installations that require an increase in the depth of the connections. The Linpac rotationally moulded pits have been designed to allow for simple conduit entry at all positions around the perimeter and the medium density, UV stabilised polyethylene ensures simple machining of the surfaces.

All pits are designed to receive either steel or concrete lids, while the larger pits have the option of rotationally moulded pit lids. These moulded lockable lids have been independently tested for load capacity and anti slip by both the University of Queensland and CSIRO laboratories.



**P5 Injection Split Pit** VP0155

## Dimensions

Code	Product	Length	Width	Height	Lid Aperture
VP0155	P5 Injection Split Pit	713mm	453mm	630mm	653mm x 400mm
UG2017	LP7 Collar	1020mm	550mm	280mm	960mm x 500mm
UG2016	LP4 Collar	710mm	400mm	225mm	650mm x 350mm
UG2010	LP5 Collar	710mm	455mm	225mm	650mm x 400mm
UG2011	LP6 Collar	1365mm	550mm	280mm	1315mm x 505mm
UG2400	LP6 Lockable Lid	650mm	500mm	90mm	-
UG2300	LP5 Lockable Lid	650mm	400mm	90mm	-
UG2200	LP4 Lockable Lid	650mm	350mm	90mm	-



**LP7 Collar** UG2017

\* All dimensions are nominal, for precise dimensions a detailed drawing should be requested



**LP4 Collar** UG2016



**LP5 Collar** UG2010



**LP6 Collar** UG2011



**LP6 Lockable Lid** UG2400



**LP5 Lockable Lid** UG2300



**LP4 Lockable Lid** UG2200



# Electrical Products

## Product Features

Linpac Rotational Mouldings have been supplying the electrical services industry with underground service pits for over 12 years. With a comprehensive range including the smaller LP1 to LP4 pits, round service pits, above ground pillars and cable entry ducts, Linpac offer the infrastructure solution to those buried connections. Linpac electrical pits offer performance and security at all times.

The electrical cable guard is moulded in UV stabilised black polyethylene. Designed to be overlapped with the moulded spigot at one end, these 1.5 metre sections can be buried or left exposed to the toughest climates in Australia. The contoured profile allows the cable guard to sit flat against telegraph poles and can be easily attached by the generous flange on either side.

## Dimensions

Code	Product	Length	Width	Height	Lid Aperture
UG2029	URDIC65 Pillar	325 mm	260 mm	625 mm	-
UG2020	LV Service Pillar	344 mm	280 mm	460 mm	-
UG2024	Cable Entry Duct	1115 mm	760 mm	670 mm	-
UG2028	URDIB65 Base	400 mm	400 mm	300 mm	-
UG2022	Service Pit x 3 Holes	435 dia	435 dia	620 mm	390 dia
UG2036	Lid "Telecommunications"	390 dia	390 dia	85 mm	-
UG2023	Service Pit	435 dia	435 dia	620 mm	390 dia
UG2040	Lid "Electricity"	390 dia	390 dia	85 mm	-
CM0029	Cable Guard	1550 mm	230 mm	150 mm	-

\* All dimensions are nominal, for precise dimensions a detailed drawing should be requested



**URDIC65 Pillar** UG2029



**LV Service Pillar** UG2020



**Cable Entry Duct** UG2024



**URDIB65 Base** UG2028



**Service Pit x 3 Holes-Lid** UG2022 - UG2036



**Service Pit-Lid** UG2023 - UG2040



**Cable Guard** CM0029

# Gas Products

## Product Features

With the need to bury gas meters and valving connections Linpac Rotational Mouldings has developed in conjunction with the Energy Authorities a series of rotationally moulded gas regulator pits. The smaller G1 has recently been upgraded to the heavily structured unit shown with the ability to receive a range of lid options from the heavy duty reinforced resin moulded lockable lid to the lighter rotationally moulded lockable lid. Whatever your requirement, Linpac have the safe option for restricted access to the control or metering equipment.

## Dimensions

Code	Product	Length	Width	Height	Lid Aperture
UG2033	G3 Pit	700mm	550mm	700mm	650mm x 500mm
UG2032	G2 Pit	560mm	460mm	450mm	510mm x 400mm
UG2031	G1 Pit	460mm	400mm	355mm	420mm x 370mm
UG2030	G3 Collar	700mm	550mm	280mm	650mm x 500mm
UG2055	G3 Lid	650mm	500mm	90mm	-
UG2037	G1 Lid	420mm	370mm	80mm	-
UG2041	G1 Resin Lid "Gas"	420mm	370mm	50mm	-
UG2042	G2 Resin Lid "Gas"	510mm	400mm	50mm	-

\* All dimensions are nominal, for precise dimensions a detailed drawing should be requested

## Optional Lids



**G1 "Gas" Resin Lid** UG2041



**G2 "Gas" Resin Lid** UG2042



**G3 Pit** UG2033



**G2 Pit** UG2032



**G1 Pit** UG2031



**G3 Collar** UG2030



**G3 Lid** UG2055



**G1 Lid** UG2037

# Water Products

## Product Features

Linpac have over the years developed an extensive range of pits suitable for the housing of control valves and meters. From the two legged round pit, water hydrant pit, rural water air valve pit, to the combined collar hydrant pit, Linpac offer the highest quality in underground products.

The strong reinforced dual skin lids are available in both the standard and snap lock varieties including embossed names such as "Hydrant", "Air Valve", "Valve" and "Sewer". The lids are also available in a range of colours that can assist in identifying the purpose of the equipment housed below.

## Dimensions

Code	Product	Length	Width	Height	Lid Aperture
WA1520	Collared Hydrant Pit	610 dia	610 dia	420mm	390 dia
WA1501	Hydrant Pit	435 dia	435 dia	420mm	390 dia
WA1506	Flushing Box	585mm	375mm	355mm	545mm x 340mm
WA1504	Rural Valve Pit	435 dia	435 dia	745mm	390 dia
WA1500	R430HV 2 Leg Pit	435 dia	435 dia	600mm	390 dia
WA1522	Snap lock Lid "Valve"	390 dia	390 dia	85mm	-
WA1521	Snap lock Lid "Hydrant"	390 dia	390 dia	85mm	-
WA1502	Lid "Hydrant"	390 dia	390 dia	85mm	-
WA1503	Lid "Sewer"	390 dia	390 dia	85mm	-
WA1510	Lid "Valve"	390 dia	390 dia	85mm	-
WA1505	Lid "Air Valve"	390 dia	390 dia	85mm	-
WA1507	Lid "Water"	545mm	340mm	50mm	-

\* All dimensions are nominal, for precise dimensions a detailed drawing should be requested

## Optional Lids



**Lid "Valve"** WA1510

"Air Valve" WA1505 - "Hydrant" WA1502 - "Sewer" WA1503 Lids are also available in this style of Lid.



**Snap Lock Lid "Valve"** WA1522

The "Hydrant" WA1521 lid is also available in this style of Snap Lock Lid.



**Collared Hydrant Pit-Lid** WA1520 - WA1521



**Hydrant Pit-Lid** WA1501 - WA1521



**Flushing Box-Lid** WA1506 - WA1507

The UV stabilised black, polyethylene flushing meter box comes with a security lid. The rotationally moulded lid offers an anti slip surface embossed with the word "WATER" and is secured with the use of a single corrosion resistant, rose head fastener.



**Rural Valve Pit-Lid** WA1504 - WA1522



**R430HV 2 Leg Pit-Lid** WA1500 - WA1522

# Road Products

## Product Features

Linpac offer underground pits that are specifically designed to suit cable installations for various Road Authorities. The 600mm service pit has been approved by Vic Roads (Approval No.96-H700-01). The smaller detector pits with optional slip resistant lockable lids, together with the reinforced J3 pits compliment this rugged market segment. The UV stabilised polyethylene pits exhibit good impact resistance and compressive strength while remaining easily machinable for those difficult connections.

## Dimensions

Code	Product	Length	Width	Height	Lid Aperture
UG2080	Vic. Roads Pit	660 dia	660 dia	1045mm	-
UG2081	Detector Pit	250mm	250mm	400mm	220mm x 220mm
UG2082	Detector Pit Lockable	250mm	250mm	400mm	220mm x 220mm
UG2083	Pit Lid	218mm	218mm	50mm	-
UG2084	Lockable Pit Lid	218mm	218mm	50mm	-
UG2086	J3 Pit	540mm	315mm	530mm	490mm x 235mm

\* All dimensions are nominal, for precise dimensions a detailed drawing should be requested



**Vic. Roads Pit** UG2080



**Detector Pit-Lid** UG2081-UG2083



**Detector Pit Lockable-Lid** UG2082-UG2084



**J3 Pit** UG2086

# Rail Products

## Product Features

From road to rail Linpac Rotational Mouldings have developed several specialised products for this challenging market. The single and larger double cabinet for signal bases offers strength, low cost and is light in weight compared to other conventional products. Made as a single wall hollow cored mouldings these cabinets are built to last.

The multi compartment cable tray is also made using this technology. Its light weight construction offers the required strength and long term performance but at a much lower cost. Designed to be laid end to end with overlapping joints the three compartment cable tray has a removable lid for cable installation and access.

The large 1000mm diameter railway pits, the 600mm diameter square to round pit and lid combination and the Platform pit have all been designed for the modern cable junction applications.



**Railway Platform Pit** UG2090

# Rail Products

## Dimensions

Code	Product	Length	Width	Height	Lid Aperture
UG2090	Platform Pit	1115mm	760mm	670mm	1070mm x 715mm
UG2072	Cable Tray	2000mm	450mm	338mm	
UG2071	Cable Tray Lid	2000mm	450mm	70mm	-
UG2073	Signal Base Single	1425mm	1165mm	530mm	-
UG2074	Signal Base Double	2400mm	1120mm	700mm	-
UG2150	Downer Pit 1000mm	1140 dia	1140 dia	550mm	1080 dia
UG2075	Round Pit 1000mm	1140 dia	1140 dia	1215mm	1080 dia
UG2550	Square to Round Pit	700mm	550mm	1115mm	650mm x 500mm
UG2400	Lid to suit UG2550	650mm	500mm	90mm	-



\* All dimensions are nominal, for precise dimensions a detailed drawing should be requested



**Railway Cable Tray-Lid** UG2072-UG2071



**Railway Single Signal Base** UG2073



**Railway Double Signal Base** UG2074



**Downer Pit 1000mm** UG2150



**Railway Pit 1000mm** UG2075



**Square to Round Pit-Lid** UG2550-UG2400

# Water Tanks Small

## Product Features

Linpac manufacture an extensive range of small freestanding tanks manufactured under the ISO 9001- 2000 quality system. Moulded in UV stabilised food grade polyethylene, complete with hygienic white interior, these one piece moulded tanks are ideal for water and food products. These tanks come standard with a 25mm BSP outlet at the base of the side wall and a 50mm overflow. The specialised filtration system isolates particles down to 1/100 th of a millimetre and are fitted as standard. A 200mm long filter bag is supplied for tanks up to 2000 litres and 360mm filter bag for the larger volumes. The filter housings, outlet and overflow are also situated at different positions, please refer to the locations diagram below.

## Dimensions

Code	Capacity	Diameter	Height	Width	Length	Location
TA1420(o)	340Lt	-	650mm	660mm	1200mm	A
TA1421(o)	450Lt	-	960mm	660mm	1200mm	B
TA1424(o)	600Lt	-	1170mm	660mm	1200mm	B
TA1422	600Lt	840mm	1520mm	-	-	C
TA1427	1100Lt	1060mm	1720mm	-	-	C
TA1423	1300Lt	1100mm	1680mm	-	-	C
TA1425	2000Lt	1300mm	1870mm	-	-	D
TA1428	3300Lt	1580mm	2010mm	-	-	D
TA1412(s)	4500Lt	2160mm	1500mm	-	-	D
TA1413	4500Lt	1830mm	1950mm	-	-	D

(o) Oval (s) Squat Tank \* All dimensions are nominal, for precise dimensions a detailed drawing should be requested

## Filter Locations

- Outlet
- Overflow
- Inlet

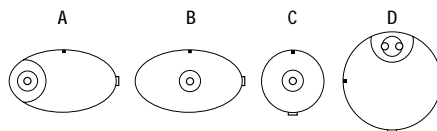

## Small Tank Fittings



25mm Outlet



Outlet Tap



50mm Overflow

## Tank Stands



- Standard tank stand to suit TA1422 (shown)
- Oval tank stands are also available to suit TA1421 and TA1424

## ø200mm Filter System



- Colour matched filter housing.
- The filter housing lid has a 50mm knockout inlet and easily removable lid.
- Easily maintained leaf strainer.
- The final filter, filters foreign objects down to 10 micron and is designed to easily lift out for cleaning.



**TANKMASTRA™**

# Water Tanks Large

## Product Features

The large TANKMASTA™ range offers circular tanks up to a massive 45000 litres capacity. Made from food grade UV stabilised polyethylene in a range of colours that match the latest roofing schemes. The pure white interior increases the opacity to sunlight preventing the growth of algae.

The polyethylene tanks offer excellent resistance to impact and require minimum site preparation. The moulded polyethylene strainer housings offer the ability to utilise two 90mm inlet positions. The new tank designs offer self supporting roof profiles that provide additional strength to the roof of the tank. "TANKMASTA™ leads the way in water storage"

## Dimensions

Code	Capacity	Diameter	Height	Filter Bag
TA1414	5600Lt	1900mm	2400mm	350mm
TA1415(s)	5900Lt	2450mm	1570mm	350mm
TA1402(s)	10000Lt	3100mm	1640mm	350mm
TA1403	12000Lt	2600mm	2650mm	1100mm
TA1404	16200Lt	2960mm	2750mm	1100mm
TA1407	22800Lt	3630mm	2500mm	1100mm
TA1405	25000Lt	3670mm	2750mm	1100mm
TA1406	27000Lt	3650mm	3100mm	1100mm
TA1408	35000Lt	4560mm	2560mm	1100mm
TA1410	45000Lt	4560mm	3100mm	1100mm

(s) Squat Tank \* All dimensions are nominal, for precise dimensions a detailed drawing should be requested

## Standard Colour Range

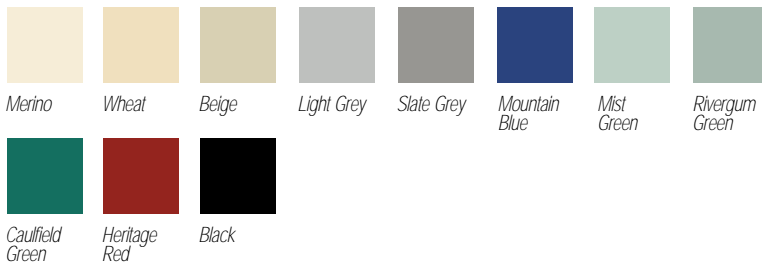

## Large Tank Fittings



38mm Outlet



Ball Valve



Brass Gate Valve



90mm Meshed Overflow

## ø360mm Filter System



- Colour matched filter housing.
- Two 90mm inlet positions in filter housing.
- 38mm Outlet and 38mm Gate or Ball valve.
- Filter/Strainer, Outlet, Gate or Ball valve and 90mm Overflow included.
- Other fittings available on request e.g fire hose adaptors.
- Filter bag can be removed for cleaning.

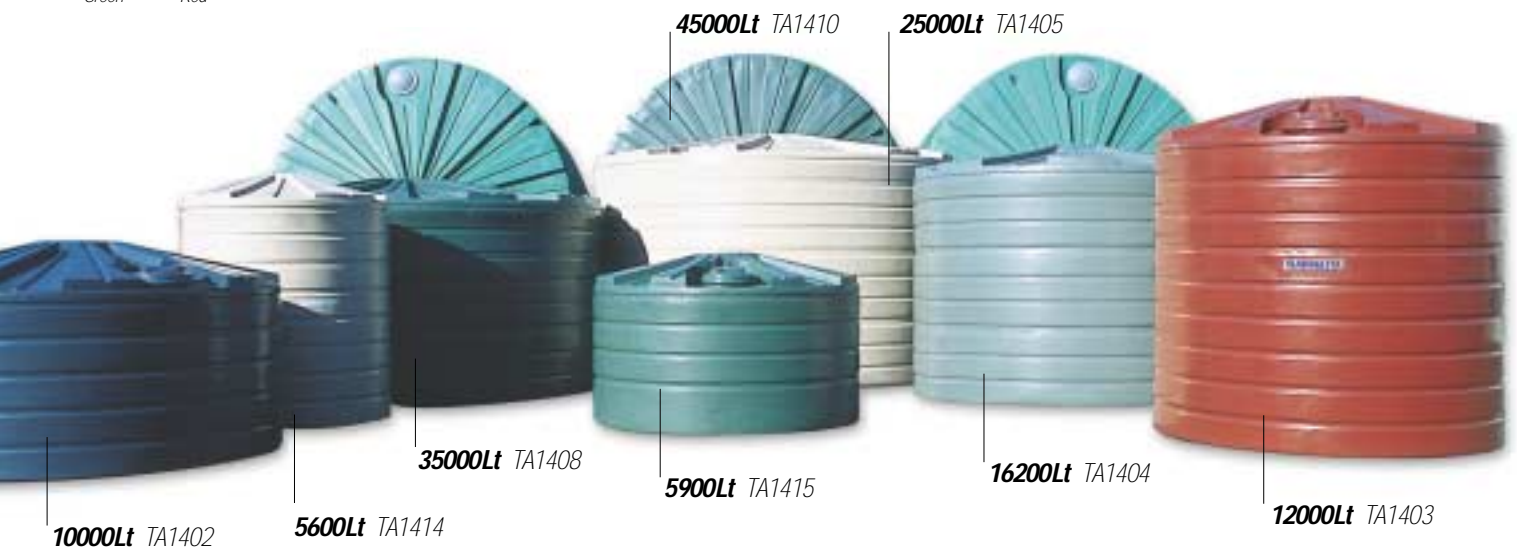

# Underground Tanks & Rural Products

## Septic Tank Features

The 3060 litre septic tank is pre-assembled before delivery including the internal baffle dividing the tank into 2/3 / 1/3 compartments as per Australian Standard AS1546.1. This septic tank is designed, manufactured and approved to AS/NZS 1546.1 and is a Certified Product with Licence number 20051. Linpac Rotational Mouldings manufacturing plants are certified to Quality Assurance ISO9001.

## Septic Tank Dimensions

Code	Capacity	Diameter	Base Diameter	Height
ST1465	3060Lt	1950mm	1600mm	1985mm

\* All dimensions are nominal, for precise dimensions a detailed drawing should be requested



**3060Lt Septic Tank** ST1465

## Underground Tank Features

Linpac Tankmasta offers a range of underground tanks from 1000 to 7500 litres in capacity. The 2000 litre tank TA2002 has a flat bottom to minimise the required excavation depth whilst all other tanks are a reinforced barrel configuration. Each tank has a riser chamber with a screw or hinge lid. The 2000 litre tank has an inbuilt filtration screen inside the riser to remove debris from the incoming stormwater. Separate filter pits are also available.

All underground tanks can be fitted with the Aquasource Remote mains water by pass system and a submersible pump for the automatic use of the harvested rainwater for flushing toilets and sprinkling gardens. If there is no rainwater available in the tank or in the event of power failure the Aquasource automatically switches to mains water so a water supply is always connected. These underground tanks are ideal for retention / detention or buffering of stormwater as generally required by local government authorities and then re-use of that water.

## Underground Tank Dimensions

Code	Capacity	Length	Width	Height	Lid Aperture
TA2003	1000Lt	1529mm	975mm	1019mm	410mm
TA2004	1500Lt	1600mm	1150mm	1213mm	410mm
TA2002	2000Lt	3070mm	1700mm	1000mm	530mm
TA2009	2000Lt	2350mm	1230mm	1360mm	470mm
TA2005	2500Lt	2072mm	1479mm	1464mm	410mm
TA2006	3000Lt	2355mm	1520mm	1650mm	470mm
TA2007	5000Lt	2200mm	2055mm	2185mm	470mm
TA2008	7500Lt	2840mm	2160mm	2270mm	550mm

\* All dimensions are nominal, for precise dimensions a detailed drawing should be requested



**2000Lt Underground Tank** TA2002



**5000Lt Underground Tank** TA2007

## Trough Dimensions

Code	Capacity	Diameter	Length	Width	Height
AG1036	1365Lt	1830mm	-	-	600mm
AG1037	1365Lt	2480mm	-	-	320mm
AG1038	3400Lt	2950mm	-	-	490mm
AG1039	3720Lt	3600mm	-	-	380mm
AG1060	200Lt	-	1500mm	610mm	375mm
AG1061	400Lt	-	2700mm	610mm	375mm
AG1062	600Lt	-	3900mm	610mm	375mm

\* All dimensions are nominal, for precise dimensions a detailed drawing should be requested



**1365Lt Trough** AG1036



# Rural Products

## Headwall & Box Culvert Dimensions

Code	Description	Collar	Length	Width	Height
IN4620	Headwall	315mmID	650mm	1600mm	650mm
IN4621	Headwall	300mmID	650mm	1600mm	650mm
IN4603	Box Culvert	-	2100mm	600mm	600mm

\* All dimensions are nominal, for precise dimensions a detailed drawing should be requested

## Molasses Lick Dimensions

Code	Capacity	Diameter	Length	Width	Height
TA1448	440Lt	-	1100mm	785mm	620mm
TA1449	1360Lt	1950mm	-	-	865mm

\* All dimensions are nominal, for precise dimensions a detailed drawing should be requested

## Cup & Saucer Dimensions

Code	Total Capacity	Trough Diameter	Tank Diameter	Trough Height	Total Height
CS1100	4200Lt	2440mm	1580mm	320mm	2010mm
CS1110	6200Lt	2440mm	1900mm	320mm	2400mm
CS1111	7780Lt	3050mm	1900mm	490mm	2400mm
CS1120	17400Lt	3660mm	2960mm	390mm	2750mm

\* All dimensions are nominal, for precise dimensions a detailed drawing should be requested

## Rural Products

Complimenting the broad Tankmasta range of water storage tanks are the Rural products covering troughs, molasses tanks and licks, cup and saucers, spray / transporter tanks and culvert headwalls. All these products come in a range of sizes and are available through the wide Tankmasta Rural Dealer network. For further information call 1800 658 265.

## Headwall Features

The headwall features a separate collar which in turn can be supplied in sizes to suit the full range of plastic and concrete pipes. This enables the headwall to be fitted to a new pipe in a new installation or can be retro-fitted to an existing pipe in the ground. The headwall has peg down holes for positioning and can be ballasted with water fill.

The 600mm box culvert can be used as an open culvert or can have the ribbed half pipe added as a cover to stop water evaporation. The culvert and half pipe are welded in place by electrofusion. Ideal for upgrade of open irrigation channels.

## Cup & Saucer Features

This range features various capacities and trough heights suitable for cattle or sheep. The products are available in the normal Tankmasta colour range and float valves and fittings are included.



**Molasses Lick (2 wheel)** TA1448



**Molasses Lick (4 wheel)** TA1449



**Cup & Saucer** CS111



**200Lt Long Trough** AG1060



**Box Culvert** IN4603



**Headwall & Collar** IN4620

# Retail Garden

## Product Features

Now it's even easier to bring nature indoors with a Plantmasta Planter Pot from LINPAC. With eleven different sizes and styles to choose from, and a range of fabulous colours, there's bound to be a Plantmasta Planter Pot that is just right for everyone. Plantmasta Planter Pots are perfect both indoors or outside and, best of all, you'll be pleasantly surprised by our competitive prices.

Our rotationally moulded Plantmasta Planter Pots are available in a great range of styles and colours that promise to enhance any decor. Whether it's terracotta, green, black, charcoal, light grey or sand that your customer is looking for, talk to us first.

We have Plantmasta Planter Pots ideal for desktops, foyers or any other indoor or outdoor area. You can choose between vases, troughs, squares, bowls, cylinders or pedestals - all in a range of sizes to suit your customers' needs.

Even our largest Plantmasta Planter Pots are easily moved around due to the use of a special light weight polymer. Our terracotta-style pots have a solid chunky look that's right for today's lifestyle - without the weight of their clay counterparts.



1140mm Trough Planter

### Dimensions

Code	Style	Height	Length	Width	Diameter
NP4003	Vase	640mm	-	-	750mm
NP4002	Vase	460mm	-	-	510mm
NP4001	Vase	360mm	-	-	430mm
NP4020	Square	420mm	460mm	460mm	-
NP4011	Trough	420mm	1140mm	490mm	-
NP4010	Trough	290mm	970mm	390mm	-
NP4022	Mediterranean	330mm	380mm	380mm	-
NP4021	Mediterranean	200mm	230mm	230mm	-
NP4050	Pedestal	700mm	-	-	295mm
NP4030	Urn	190mm	-	-	430mm
NP4040	Cylinder	160mm	-	-	455mm

\* All dimensions are nominal, for precise dimensions a detailed drawing should be requested



750mm Vase Planter NP4003



1140mm Trough Planter NP4011



700mm Pedestal Planter NP4050

# Retail Garden

## Features

Plantmasta Planter Pots are virtually unbreakable. They're not affected by water or plant chemicals, they don't chip or leak, and they've been UV stabilised for longer life. We're so confident of our product that we issue a standard ten year guarantee against chipping, cracking and breakage in normal use.

It's easy to drill holes in a Plantmasta Planter Pot for water drainage. What's more, Plantmasta is fully-compatible with all leading self watering systems.

## Planter Pots Standard Colours

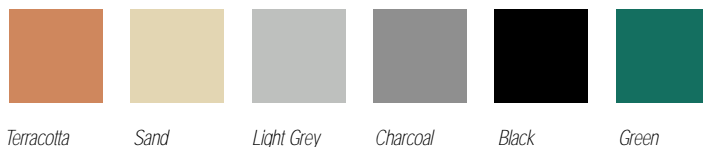

**510mm Vase Planter** NP4002



**430mm Vase Planter** NP4001



**460mm Square Planter** NP4020



**970mm Trough Planter** NP4010



**380mm Mediterranean Planter** NP4022



**230mm Mediterranean Planter** NP4021



**430mm Urn Planter** NP4030



**455mm Cylinder Planter** NP4040

**PLANTMASTA™**

# Custom Moulding

## CAD Design Facilities

Your needs are the driving force in our product development. At Linpac, we offer the ability to turn good ideas into great products. It is the customer who determines what we develop, what we produce and ultimately what we sell. The development of a partnership with our customers forms the basis for creating a new product. Custom moulding is the result!

At Linpac we have the ability to take an idea and turn it into a finished product utilising the rotational moulding process. To assist our customers, Linpac offers the latest design and moulding technology with the capability of producing parts that range from 2 litres up to 45,000 litres. Rotational moulding is an incredibly versatile process that can produce products that vary in size, shape and structure.

Materials that are just as diverse, all the colours of a rainbow, cost effective tooling and the ability to produce economically small production runs gives Linpac the means to produce what you need, on time and within budget. So where do you go from here... simply call our office and the Linpac staff will take you from start to finish. Together we will create something special.



## Inhouse Design Facility

Photograph of Linpac Rotational Mouldings Pty.Ltd Design department



## Automotive Componentry

ADI Ventilation ducts and cabin covers are rotationally moulded in Linear medium density polyethylene incorporating brass insert attachment points and trimmed to tolerance. Both fully enclosed mouldings and open surfaces with a high cosmetic finish can be produced with this process. Tooling has been produced from cast aluminium with a textured finish.

## ADI Auto parts

Photograph courtesy of Australian Defence Industries

## Commercial Products

Traveldock is a Portable floatation module that combines buoyancy, strength and aesthetics as a hollow one piece fully enclosed moulding. With built in carry handles, reinforced support mounts and heavily ribbed upper deck with embossed logo, this product maximises the benefits of the rotational moulding process.



## Traveldock

Photograph courtesy of Traveldock



## Marine Products

Marine applications are ideal for rotational moulding. Low volumes, specialised profiles, Light weight, corrosion resistance and cosmetic surface finishes are features that are highlighted in the hollow seat shell shown above.

## Bucket Seat

Photograph courtesy of Sant Marine

# Rotational Moulding Process

## The Moulding Process

The rotational moulding process offers a range of advantages to the designer, including uniform or variable wall thickness, strong outside corners, variety of finishes and colours and virtually stress free mouldings. The simple moulding process also allows for low cost tooling without the need for an internal core as well as offering a short lead time. It is possible to load many moulds on the same arm of the machine to offer better output and reduce production cost.

- (1) Powdered resin is introduced to the mould. The mould is placed into a heated environment.
- (2) It is then rotated biaxially, ensuring even distribution of the material within the mould.
- (3) The mould enters the cooling cycle. While still rotating air and water are applied to the outside of the hot mould. The internal resin solidifies as the mould is cooled.
- (4) Once cooled the mould is opened and the part is removed. The product is now ready to be fitted out in our Secondary Operations facility if required.



Typical multi arm carousel rotational moulding machine, showing oven, cooling chamber and loading / unloading area.

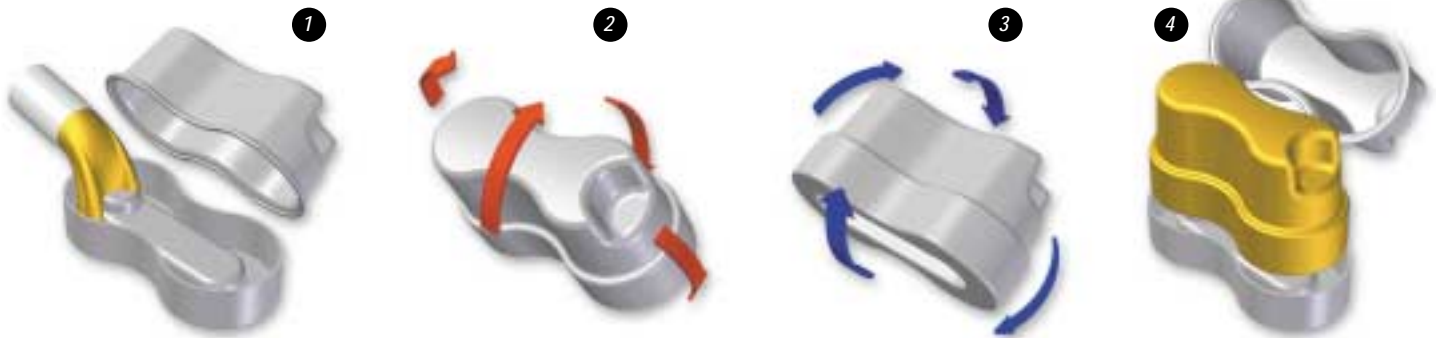

## Mold-in Graphics™

To complete the finish of the moulding there are several options to promote the corporate image, brand or to provide simple instructions. They can be moulded in an embossed image (by use of an engraved plate inside the mould), an adhesive label or applied as a Mold-in Graphic™.

Mold-in Graphics™ or MIG's, are literally labels made from resin that are moulded onto the surface of the product during manufacture and becomes an integral part of the product. The result is a graphic that is impervious to chemicals and solvents and can withstand the effects of pressure washing. They will not fade and are UV resistant.



**Rubbish Chute**

Photograph courtesy of BTC Booths Hire Pty.Ltd

## Standard Colour Range

Linpac Rotational Mouldings offer both a range of different resins and a variety of standard colours to suit almost any application. Depending on the environment, structural cost and cosmetic requirements we can assist you with that critical selection. Below is the spectrum of colours ranging from solid one colour materials to stone effect options.

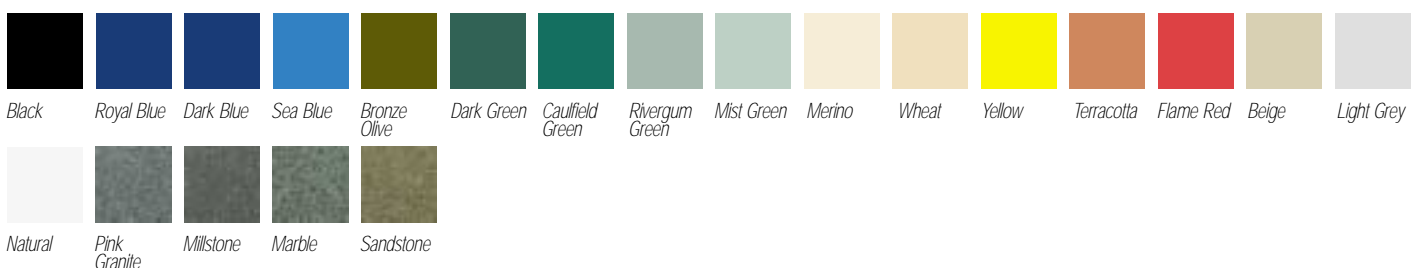

# Chemical Resistance

## Chemical Resistance Chart

Code		Med Density 21°C	Polyethylene 50°C	Code		Med Density 21°C	Polyethylene 50°C
<b>A</b>	Acetic Acid (60%)	●	▲	<b>A</b>	Inks	●	●
	Alums (all types)	●	●		Magnesium Hydroxide (9sat'd)	●	●
	Ammonia (100% dry gas)	●	●	<b>A</b>	Methyl Alcohol (100%)	●	●
	Ammonium Hydroxide	●	●		Milk	●	●
<b>BP</b>	Amyl Acetate (100%)	■	■	<b>P</b>	Mineral Oils	▲	■
<b>AP</b>	Amyl Alcohol (100%)	●			Molasses	●	●
<b>P</b>	Amyl Chloride (100%)	■	■	<b>O</b>	Nitric Acid (70%)	●	■
<b>BP</b>	Aromatic Hydrocarbons	■	■	<b>O</b>	Nitric Acid (95-98%)	■	■
	Barium Hydroxide	●	●		Planting Solutions		
<b>BP</b>	Benzene	■	■	<b>A</b>	Brass	●	●
	Brine	●	●	<b>A</b>	Cadmium	●	●
<b>O</b>	Bromide (liquid)	■	■	<b>A</b>	Copper	●	●
<b>B</b>	Butter	■	■	<b>A</b>	Gold	●	●
	Calcium Hydroxide (conc)	●	●	<b>A</b>	Lead	●	●
	Calcium Hypochlorite (Bleach solution)	●	●	<b>A</b>	Nickel	●	●
<b>BP</b>	Camphor Oil	■	■	<b>A</b>	Silver	●	●
	Carbon Dioxide (all conc)	●	●	<b>A</b>	Tin	●	●
<b>A</b>	Caster Oil (conc)	●	●	<b>A</b>	Zinc	●	●
<b>BP</b>	Chloroform	▲	■		Potassium Dioxide (conc)	●	●
<b>A</b>	Cider	●	●	<b>A</b>	n-Propyl Alcohol	●	●
<b>A</b>	Citric Acid (sat'd)	●	●		Sea Water	●	●
<b>A</b>	Cola Concentrates	●	●	<b>A</b>	Shortening	●	●
<b>A</b>	Detergents, Synthetic	●	●	<b>A</b>	Soap Solution ( any conc)	●	●
	Developers, Photo	●	●		Sodium Hydroxide ( conc)	●	●
<b>A</b>	Emulsions, Photo	●	●		Sodium Hypochlorite	●	●
<b>A</b>	Ethyl Alcohol (100%)	●	●	<b>A</b>	Starch Solution ( sat'd)	●	●
	Ferric Chloride (sat'd)	●	●	<b>A</b>	Stearic Acid (100%)	●	●
	Ferric Nitrate (sat'd)	●	●	<b>O</b>	Sulphuric Acid (70%)	●	▲
<b>A</b>	Fish Solubles	●	●	<b>O</b>	Sulphuric Acid (80%)	●	■
	Fluosilicic Acid (conc)	▲	▲		Sulphurous Acid	●	●
	Formic Acid (all conc)	●	●	<b>P</b>	Turpentine	■	■
<b>B</b>	Fruit Pulp	●	●		Urea (0-30%)	●	●
<b>BP</b>	Gasoline	▲	■	<b>A</b>	Vegetable Oils	●	●
	Glucose	●	●		Vinegar	●	●
	Hydrochloric Acid (all conc)	●	●		Water	●	●
	Hydrofluoric Acid (60%)	●	●	<b>B</b>	Wines	●	●

This table is an initial guide only. Please contact our sales department for further inquiries on 1300 366 685 concerning the suitability of your particular application.

- O** Oxidiser
- P** Plasticizer
- B** Suspected stress crack agent
- A** Known stress crack agent
- Resistant
- ▲ Variable Resistance
- Not Resistant

## Material Specifications

The table above offers the chemical resistance of Linear Medium Density Polyethylene for a range of products at 2 different temperatures. More detailed charts are available on request. Please ensure that all components are compatible with the contents of the container.

Linpac Rotational Mouldings Pty Ltd shall not accept liability of any kind arising out of misuse of the product or use for any other purpose than its intended use as contained herein. All information supplied in this brochure was correct at time of printing. Linpac Rotational Mouldings Pty Ltd reserves the right to change specifications, colours and designs without further notice.

# Terms & Conditions

By accepting delivery, the purchaser agrees to the supplying of products by Linpac Rotational Mouldings on these terms and conditions which subject to legislation shall constitute the agreement between the parties to the exclusion of any purchase order, conditions or other documents submitted by the purchaser.

## **(1) Prices and Payment**

Prices published in the Linpac Rotational Mouldings current price list are recommended prices only and are subject to change without notice. Unless otherwise stated, payment terms are thirty days from the end of month in which the goods are purchased. Purchase discounts (if any) will be allowed at the rates agreed in writing between Linpac Rotational Mouldings and the customer.

## **(2) Quotations**

Unless previously withdrawn, quotations given by Linpac Rotational Mouldings may be accepted only within the period stated or, where no period is stated, within sixty days of the quotation date.

## **(3) GST**

Unless otherwise stated all product prices quoted by Linpac Rotational Mouldings are net, exclusive of GST. Linpac Rotational Mouldings will include GST in accordance with rulings in force at the time of invoicing. Invoices will also meet the requirements of those rulings.

## **(4) Cancellation & Returns**

Orders may be cancelled by the purchaser only with the written consent of Linpac Rotational Mouldings and on terms, which will indemnify Linpac Rotational Mouldings against any loss. Products returned for credit must be returned to Linpac Rotational Mouldings with packing slip and invoice number within 14 days of original delivery. Goods will only be accepted for credit if they have returned undamaged and free into our warehouse within 14 days. Goods manufactured to customers specifications will not be accepted for credit.

## **(5) Storage**

Linpac Rotational Mouldings reserves the right to make a reasonable charge for storage if delivery instructions are not provided by the purchaser within 14 days of a request by Linpac Rotational Mouldings for such information.

## **(6) Delivery**

The delivery times made known to the purchaser are estimates only and Linpac Rotational Mouldings shall not be liable for late delivery or non-delivery. Under no circumstance shall Linpac Rotational Mouldings be liable for any loss, damage or delay occasioned to the purchaser for non-delivery or late installation of the products. Unless otherwise stated, published prices are F.O.B. ex Melbourne.

## **(7) Loss or Damage in Transit**

Linpac Rotational Mouldings is not responsible for any loss or damage to products in transit or thereafter. Linpac Rotational Mouldings render the purchase such assistance as may be necessary to press claims on carriers provided the purchaser shall notify Linpac Rotational Mouldings and the carrier in writing immediately loss or damage is discovered on receipt of products and shall lodge a claim on the carrier within 3 days of the receipt of the products or in the case of non delivery within 3 days of the date when delivery was due.

## **(8) Rights in Relation to Products**

Until products are fully paid Linpac Rotational Mouldings shall: (i) retain ownership of the products; (ii) have the unrestricted right to enter the purchaser's premises (or premises of any associated company or agent where the products are located) without liability for trespass or any resulting damage and re-take possession of the products; and (iii) be entitled to keep or re-sell any products so re-possessed. If products are re-sold, or products manufactured using the products, are sold by the purchaser and Linpac Rotational Mouldings has not been paid for the products, the purchaser shall hold the proceeds of any such sale as represents the invoice price of the products sold or used in the manufacture of the products sold on trusts for Linpac Rotational Mouldings and shall deposit such proceeds in a separate identifiable account and shall pay such amount to Linpac Rotational Mouldings upon request. Nothing herein shall limit or exclude the remedies available to Linpac Rotational Mouldings including its entitlement to maintain an action against the purchaser for the purchase price of the products.

## **(9) Performance and Description**

All Products to be supplied by Linpac Rotational Mouldings shall be as described on the purchase order which description shall prevail over all other descriptions, including any purchaser's specification or enquiry. Any performance figures given by Linpac Rotational Mouldings are estimates only. Linpac Rotational Mouldings shall be under no liability for damages for failure to attain such figures unless specifically guaranteed in writing and any such written guarantee shall be subject to the recognised tolerances applicable to such figures. Advice given by Linpac Rotational Mouldings whether in relation to its own products or third party products, however communicated is given in good faith but any liability deriving from that advice will be limited in accordance with Clause 11 of these terms and conditions. The purchaser must ensure the products are suitable for the purposes they are proposed to be used for.

## **(10) Warranty**

(i) Linpac Rotational Mouldings agrees in respect of products it manufactures to make good any defects by repairing the same or at Linpac Rotational Mouldings option replacement or payment of an amount equal to the cost to repair or replacement, within a period not exceeding 12 months after the products have been dispatched, provided that: (a) defects have arisen solely from faulty material or workmanship; (b) the products have not been subjected to maltreatment, or interference; (c) the failure or defect has not been the result of inattention by the purchaser; (d) instruction specified for the products have been strictly complied with and the products have been used or operated on the conditions and for the purposes specified; (e) other products or accessories used by the purchaser in conjunction with the products are manufactured by or approved by Linpac Rotational Mouldings; (f) any seals which are on the products remain unbroken; and (g) the defective parts are promptly returned at no charge to Linpac Rotational Mouldings. (ii) In the case of products not manufactured by Linpac Rotational Mouldings the guarantee of the manufacturer thereof shall be accepted by the purchaser and is the only guarantee given to the purchaser in respect of the products; (iii) The above warranties are in addition to the benefit of all implied conditions and warranties in favour of and remedies of the purchaser under or pursuant of statute or common law, the operation of which cannot be excluded. (iv) Except as provided above, all representation, express and implied warranties, guarantees and conditions as to merchantability, description, quality or suitability and fitness of the products for any purposes, whether as to design, assembly, installation, materials, workmanship or otherwise are expressly excluded. (v) Linpac Rotational Mouldings liability for breach of the express warranties provided herein, for breach of the Trade Practices Act or like legislation, for breach of conditions or warranties implied by law which cannot be excluded or for breach of a duty of care, is strictly limited in the case of supply of products to repair of the replacement of or payment for, the products in accordance with the conditions in clause 11 (i) and in the case of services to the resupply of the service or an equivalent service or at Linpac Rotational Mouldings option an amount equivalent to the cost supply of the service or an equivalent service. (vi) In no event shall Linpac Rotational Mouldings be liable for any incidental, indirect, special, or consequential losses or damages, in relation to the supply of products or services by Linpac Rotational Mouldings whether arising out of breach of the warranties provided herein, express or implied warranties, breach of the Trade Practices Act, or other legislation, breach of any duty of care or in any way whatsoever to any person, corporation or other entity. (vii) Subclauses 11 (v) and (vi) do not apply to the rights conferred and liabilities under the provisions of Part VA of the Trade Practices Act.

## **(11) Advertising**

The purchaser acknowledges that it shall not on sell, or dispose of or advertise the sale or disposal of the products purchased by it without first obtaining the consent in writing of Linpac Rotational Mouldings. The purchaser indemnifies Linpac Rotational Mouldings against any liability, loss, claim, expense or demand arising from any false, misleading, deceptive or untrue representation or statement made by the purchaser to any person concerning the products.

## **(12) Force Majeure**

If Linpac Rotational Mouldings is unable to perform in whole or in part any obligation under this agreement by reason of any fact, circumstance or matter beyond the reasonable control of Linpac Rotational Mouldings, including strikes, lock outs, raw material shortages, accidents or breakdowns of plant or equipment. Linpac Rotational Mouldings shall be relieved of those obligations to the extent and for the period that it is so unable to perform and shall not be liable to any party in respect of such inability.

## **(13) Further Dealing**

Unless otherwise agreed to in writing, the terms and conditions applying herein apply to all agreements for the supply of products and services by Linpac Rotational Mouldings to the purchaser.

## **(14) Entire Agreement**

The above terms and conditions represent the entire agreement between Linpac Rotational Mouldings and the purchaser with respect to the products and services supplied hereunder and the agreement cannot be modified except by a new written contract executed by both Linpac Rotational Mouldings and the Purchaser.

## **(15) Place of Contract - Governing Law**

This agreement is made in Victoria and the conditions of supply shall be governed and construed in accordance with the laws in force in Victoria.



Linpac Head Office and Manufacturing Plant, Carrum Downs, Victoria, Australia.

*Notes*

**LINPAC Rotational Mouldings Pty. Ltd.**

81 Frankston Gardens Drive  
Carrum Downs, 3201, Victoria,  
Australia.

Tel: (03) 9775 0310  
Fax: (03) 9775 1639  
Sales Enquiries: 1300 366 685  
Email: [sales@linpac.com.au](mailto:sales@linpac.com.au)  
Web: [www.linpac.com.au](http://www.linpac.com.au)  
ABN: 19067462337

**LINPAC Wagga Wagga**

15 Lewington Street  
Bomen, 2650  
New South Wales, Australia.

Tel: (02) 6921 4297  
Fax: (02) 6921 9807

**LINPAC NSW**

98 Airds Road  
Minto, 2566  
New South Wales, Australia.

Tel: (02) 9820 2222  
Fax: (02) 9820 3772

**LINPAC QLD**

PO Box 83  
Banyo, 4014  
Queensland, Australia.

Tel: (07) 3267 1485  
Fax: (07) 3267 1486



N°106068



ARM



ARMA



Created Nov 2003